



Neutral conductor/PE terminal, continuous, for floor mounting, Up to 32 A, accessory for main and emergency switching-off switch 3LD2

Model			
product brand name	SETRON		
product designation	Neutral conductor/PE terminal		
design of the product	accessories for 3LD2 main and EMERGENCY-STOP switches		
AWG number as coded connectable conductor cross section			
• minimum			14
• maximum			8
type of connectable conductor cross-sections for main contacts			
• finely stranded with core end processing			1x (1.5 ... 16 mm²)
• solid or stranded			1x (1.5...10 mm²)
Approvals Certificates			
General Product Approval	other	Environment	

[Confirmation](#)



[Miscellaneous](#)

[Confirmation](#)

[Environmental Con-  
firmations](#)

Environment

[Environmental Con-  
firmations](#)

Further information

Information on the packaging  
<https://support.industry.siemens.com/cs/ww/en/view/109813875>  
Information- and Downloadcenter (Catalogs, Brochures,...)  
<http://www.siemens.com/lowvoltage/catalogs>  
Industry Mall (Online ordering system)  
<https://mall.industry.siemens.com/mall/en/en/Catalog/product?mlfb=3LD9220-2C>  
Service&Support (Manuals, Certificates, Characteristics, FAQs,...)  
<https://support.industry.siemens.com/cs/ww/en/ps/3LD9220-2C>  
Image database (product images, 2D dimension drawings, 3D models, device circuit diagrams, ...)  
[http://www.automation.siemens.com/bilddb/cax\\_en.aspx?mlfb=3LD9220-2C](http://www.automation.siemens.com/bilddb/cax_en.aspx?mlfb=3LD9220-2C)  
CAx-Online-Generator  
<http://www.siemens.com/cax>  
Tender specifications  
<http://www.siemens.com/specifications>

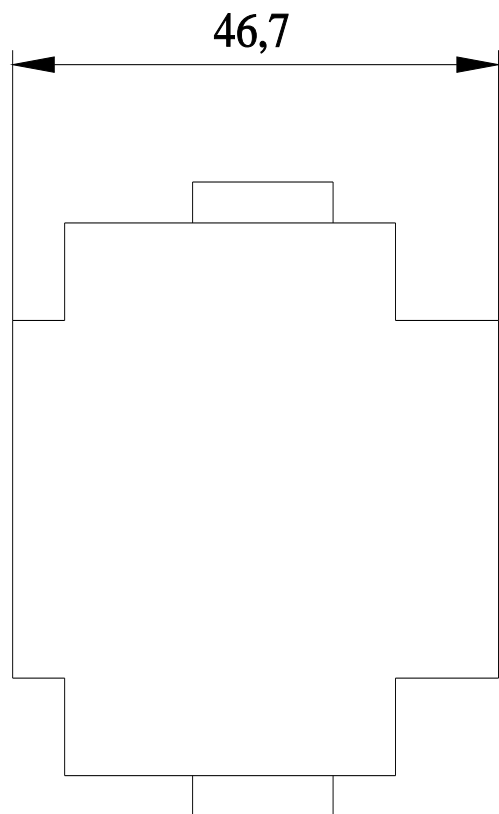
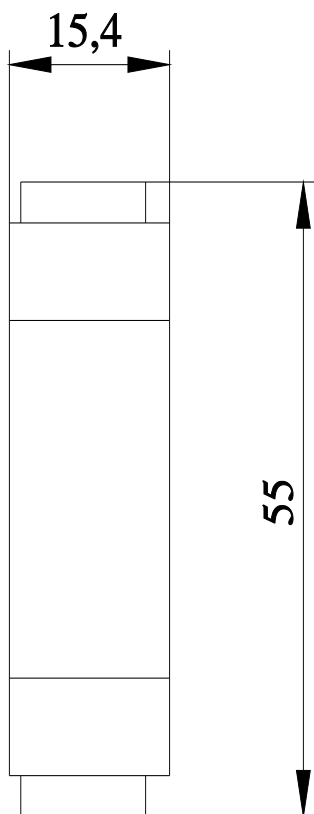

---

last modified:

4/18/2024 