



Neutral conductor, leading switching for floor mounting, for 100 A and 125 A, accessory for main and emergency switching-off switch 3LD2

Model	
product brand name	SETRON
product designation	Neutral conductor
design of the product	accessories for 3LD2 main and EMERGENCY-STOP switches
AWG number as coded connectable conductor cross section	
• minimum	12
• maximum	1
type of connectable conductor cross-sections for main contacts	
• finely stranded with core end processing	1x (4...50 mm²)
• solid or stranded	1x (4...35 mm²)
Approvals Certificates	
General Product Approval	other



[Confirmation](#)



[Confirmation](#)

other	Environment
<a href="#">Miscellaneous</a>	<a href="#">Environmental Con- firmations</a>
	<a href="#">Environmental Con- firmations</a>

Further information
Information on the packaging <a href="https://support.industry.siemens.com/cs/ww/en/view/109813875">https://support.industry.siemens.com/cs/ww/en/view/109813875</a>
Information- and Downloadcenter (Catalogs, Brochures,...) <a href="http://www.siemens.com/lowvoltage/catalogs">http://www.siemens.com/lowvoltage/catalogs</a>
Industry Mall (Online ordering system) <a href="https://mall.industry.siemens.com/mall/en/en/Catalog/product?mlfb=3LD9280-0C">https://mall.industry.siemens.com/mall/en/en/Catalog/product?mlfb=3LD9280-0C</a>
Service&Support (Manuals, Certificates, Characteristics, FAQs,...) <a href="https://support.industry.siemens.com/cs/ww/en/ps/3LD9280-0C">https://support.industry.siemens.com/cs/ww/en/ps/3LD9280-0C</a>
Image database (product images, 2D dimension drawings, 3D models, device circuit diagrams, ...) <a href="http://www.automation.siemens.com/bilddb/cax_en.aspx?mlfb=3LD9280-0C">http://www.automation.siemens.com/bilddb/cax_en.aspx?mlfb=3LD9280-0C</a>
CAX-Online-Generator <a href="http://www.siemens.com/cax">http://www.siemens.com/cax</a>
Tender specifications <a href="http://www.siemens.com/specifications">http://www.siemens.com/specifications</a>

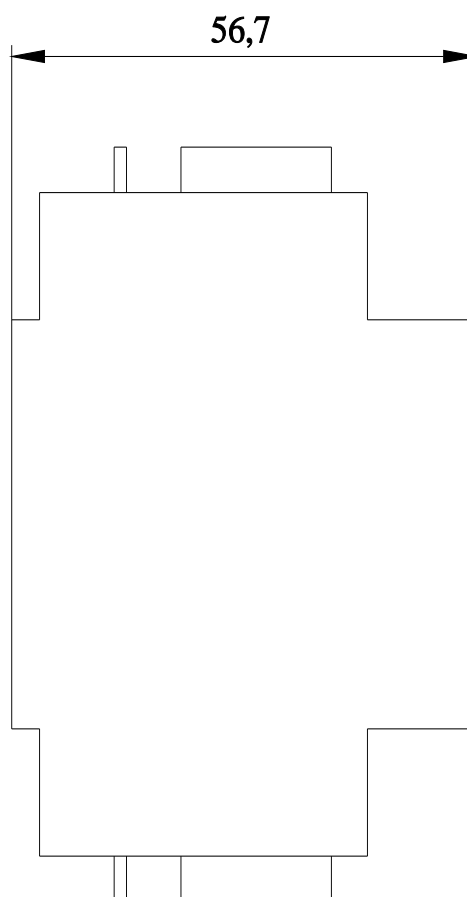
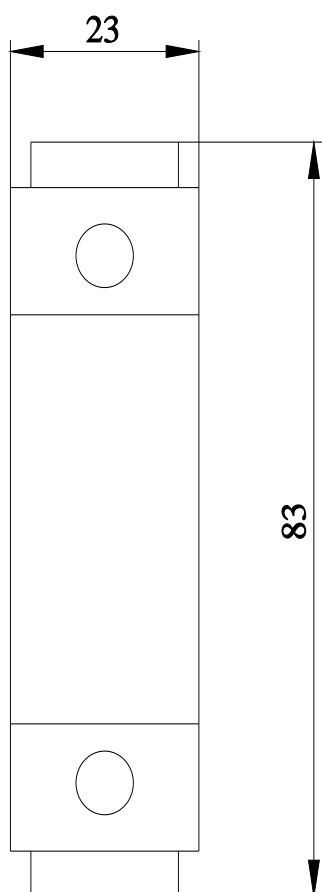

---

last modified:

4/18/2024 