



Neutral conductor/PE terminal, continuous, for Front mounting, for 100 A and 125 A, accessory for main and emergency switching-off switch 3LD2

Model	
product brand name	SETRON
product designation	Neutral conductor/PE terminal
design of the product	accessories for 3LD2 main and EMERGENCY-STOP switches
AWG number as coded connectable conductor cross section	
• minimum	12
• maximum	1
type of connectable conductor cross-sections for main contacts	
• finely stranded with core end processing	1x (4...50 mm²)
• solid or stranded	1x (4...35 mm²)
Approvals Certificates	
General Product Approval	other



[Confirmation](#)



[Confirmation](#)

other	Environment
Miscellaneous	Environmental Con- firmations
	Environmental Con- firmations

Further information
Information on the packaging https://support.industry.siemens.com/cs/ww/en/view/109813875
Information- and Downloadcenter (Catalogs, Brochures,...) http://www.siemens.com/lowvoltage/catalogs
Industry Mall (Online ordering system) https://mall.industry.siemens.com/mall/en/en/Catalog/product?mlfb=3LD9280-2B
Service&Support (Manuals, Certificates, Characteristics, FAQs,...) https://support.industry.siemens.com/cs/ww/en/ps/3LD9280-2B
Image database (product images, 2D dimension drawings, 3D models, device circuit diagrams, ...) http://www.automation.siemens.com/bilddb/cax_en.aspx?mlfb=3LD9280-2B
CAX-Online-Generator http://www.siemens.com/cax
Tender specifications http://www.siemens.com/specifications

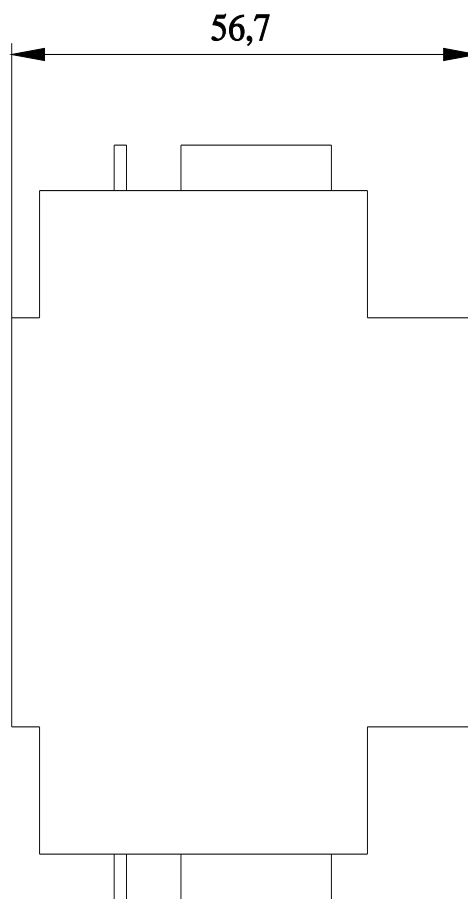
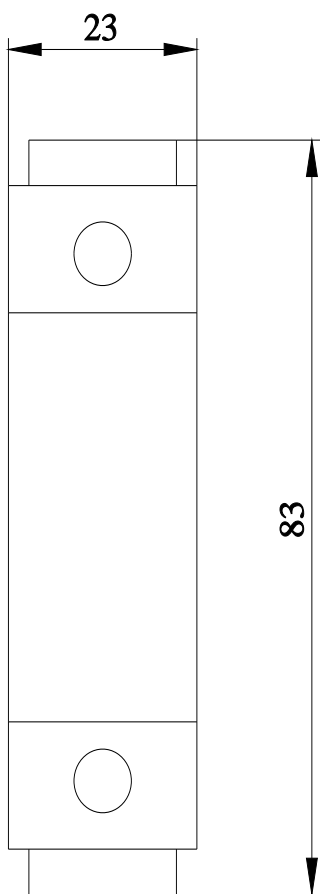

last modified:

4/18/2024 