



Neutral conductor/PE terminal, continuous, for floor mounting, for 100 A and 125 A, accessory for main and emergency switching-off switch 3LD2

| Model | |
|--|---|
| product brand name | SETRON |
| product designation | Neutral conductor/PE terminal |
| design of the product | accessories for 3LD2 main and EMERGENCY-STOP switches |
| AWG number as coded connectable conductor cross section | |
| • minimum | 12 |
| • maximum | 1 |
| type of connectable conductor cross-sections for main contacts | |
| • finely stranded with core end processing | 1x (4...50 mm²) |
| • solid or stranded | 1x (4...35 mm²) |
| Approvals Certificates | |
| General Product Approval | other |



[Confirmation](#)



[Confirmation](#)

| other | Environment |
|-------------------------------|---|
| Miscellaneous | Environmental Confirmations Environmental Confirmations |

| Further information |
|--|
| Information on the packaging https://support.industry.siemens.com/cs/ww/en/view/109813875 |
| Information- and Downloadcenter (Catalogs, Brochures,...) http://www.siemens.com/lowvoltage/catalogs |
| Industry Mall (Online ordering system) https://mall.industry.siemens.com/mall/en/en/Catalog/product?mlfb=3LD9280-2C |
| Service&Support (Manuals, Certificates, Characteristics, FAQs,...) https://support.industry.siemens.com/cs/ww/en/ps/3LD9280-2C |
| Image database (product images, 2D dimension drawings, 3D models, device circuit diagrams, ...) http://www.automation.siemens.com/bilddb/cax_en.aspx?mlfb=3LD9280-2C |
| CAX-Online-Generator http://www.siemens.com/cax |
| Tender specifications http://www.siemens.com/specifications |

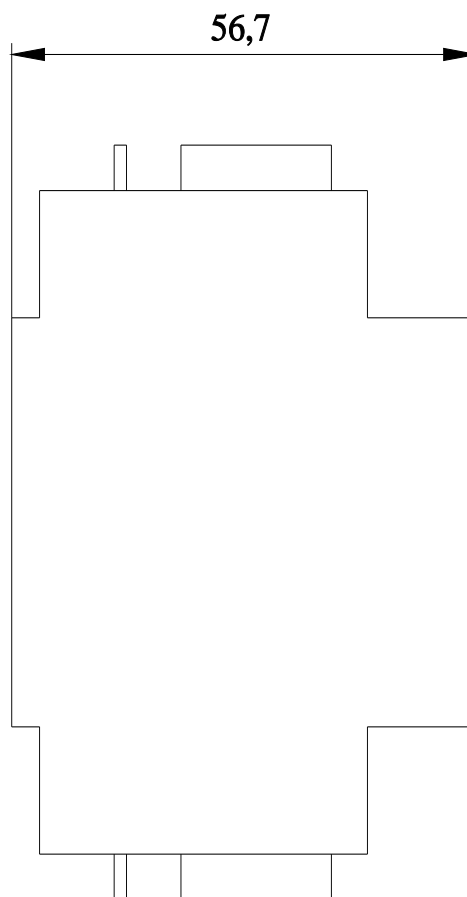
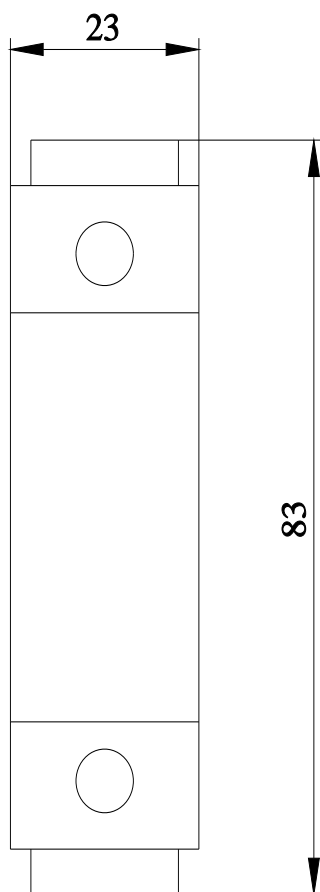

last modified:

4/18/2024 