



Terminal block 6 mm² for current outfeed and also for connection of 3-phase busbars

product brand name	SIRIUS
product category	Plugs, adapters and terminals
product designation	Terminal block
design of the product	for power outlet
General technical data	
power loss [W] for rated value of the current at AC in hot operating state per pole	1.2 W
type of calculation of power loss depending on pole	quadratic
insulation voltage with degree of pollution 3 at AC rated value	500 V
thermal current	32 A
Substance Prohibitance (Date)	10/01/2009
number of poles for main current circuit	3
operating voltage at AC rated value	500 V
operational current rated value	32 A
ampacity maximum	32 A
UL/CSA ratings	
operating voltage at AC according to UL rated value	600 V
Ambient conditions	
ambient temperature	
• during operation	-20 ... +60 °C
• during storage	-50 ... +80 °C
Environmental footprint	
Environmental Product Declaration (EPD)	Yes
Global Warming Potential [CO ₂ eq] total	9.06 kg
Global Warming Potential [CO ₂ eq] during manufacturing	0.313 kg
Global Warming Potential [CO ₂ eq] during operation	8.72 kg
Global Warming Potential [CO ₂ eq] after end of life	0.022 kg
Electrical Safety	
protection class IP on the front according to IEC 60529	IP20
touch protection on the front according to IEC 60529	finger-safe, for vertical contact from the front
Installation/ mounting/ dimensions	
height	35 mm
width	40.2 mm
depth	50.2 mm
Connections/ Terminals	
type of electrical connection for main current circuit	spring-loaded terminals
type of connectable conductor cross-sections	
• for main contacts	
— solid	1x (1.5 ... 6 mm ²)
— stranded	1x (1.5 ... 6 mm ²)

— finely stranded with core end processing	1x (1.5 ... 4 mm²)
— finely stranded without core end processing	1x (1.5 ... 6 mm²)
• for AWG cables for main contacts	1x (15 ... 10)
connectable conductor cross-section for main contacts	
• solid or stranded	1.5 ... 6 mm²
• stranded	1.5 ... 6 mm²
• finely stranded with core end processing	1.5 ... 4 mm²
• finely stranded without core end processing	1.5 ... 6 mm²
AWG number as coded connectable conductor cross section for main contacts	15 ... 10

Approvals Certificates

General Product Approval	Test Certificates
--------------------------	-------------------



[Confirmation](#)



[Type Test Certificates/Test Report](#)

Test Certificates	Marine / Shipping
-------------------	-------------------

[Special Test Certificate](#)



Marine / Shipping	other	Railway	Environment
-------------------	-------	---------	-------------



[Miscellaneous](#)

[Confirmation](#)



[Special Test Certificate](#)



Environment

[Environmental Confirmations](#)

Further information

Information on the packaging

<https://support.industry.siemens.com/cs/ww/en/view/109813875>

Information- and Downloadcenter (Catalogs, Brochures,...)

<https://www.siemens.com/ic10>

Industry Mall (Online ordering system)

<https://mall.industry.siemens.com/mall/en/en/Catalog/product?mlfb=3RV2917-5D>

Cax online generator

<http://support.automation.siemens.com/WW/CAXorder/default.aspx?lang=en&mlfb=3RV2917-5D>

Service&Support (Manuals, Certificates, Characteristics, FAQs,...)

<https://support.industry.siemens.com/cs/ww/en/ps/3RV2917-5D>

Image database (product images, 2D dimension drawings, 3D models, device circuit diagrams, EPLAN macros, ...)

http://www.automation.siemens.com/bilddb/cax_de.aspx?mlfb=3RV2917-5D&lang=en

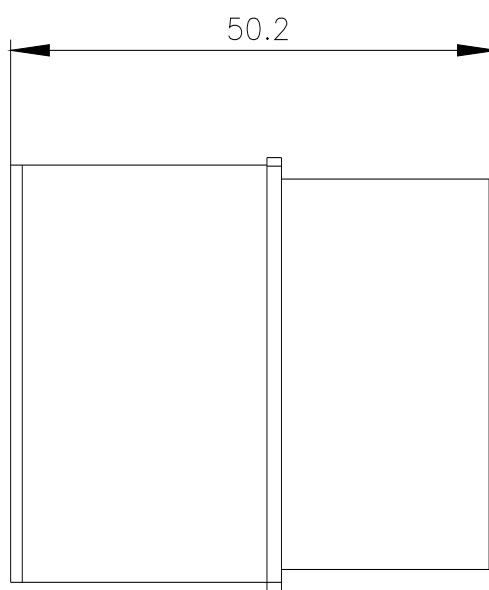
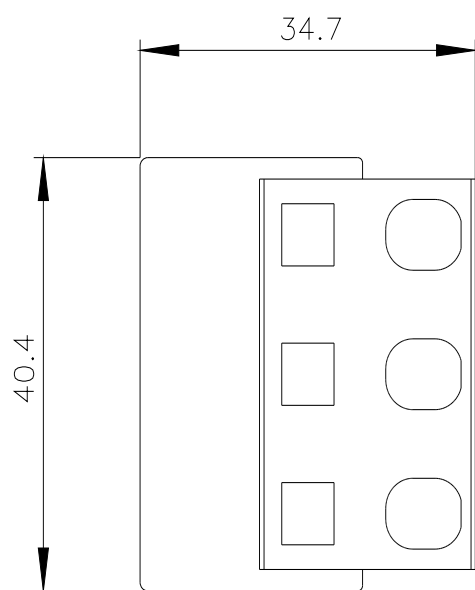

last modified:

1/10/2024 