







door mounted rotary operator standard IEC IP65 with door interlock 24 V DC
lighting kit accessory for: 3VA10/11

Model				
product brand name		SETRON		
accessories		Door-coupling rotary operating mechanisms		
General technical data				
protection class IP		IP65		
Mechanical Design				
height		70 mm		
width		77 mm		
Certificates				
General Product Approval		EMV	Test Certificates	
 EG-Konf.		Miscellaneous	  RCM	Type Test Certificates/Test Report
Marine / Shipping		other		Environment
 LRS	Miscellaneous	Confirmation	Miscellaneous	Environmental Confirmations Environmental Confirmations

Further information	
Information on the packaging https://support.industry.siemens.com/cs/ww/en/view/109813875	
Information- and Downloadcenter (Catalogs, Brochures,...) http://www.siemens.com/lowvoltage/catalogs	
Industry Mall (Online ordering system) https://mall.industry.siemens.com/mall/en/en/Catalog/product?mlfb=3VA9157-0FK23	
Service&Support (Manuals, Certificates, Characteristics, FAQs,...) https://support.industry.siemens.com/cs/ww/en/ps/3VA9157-0FK23	
Image database (product images, 2D dimension drawings, 3D models, device circuit diagrams, ...) http://www.automation.siemens.com/bilddb/cax_en.aspx?mlfb=3VA9157-0FK23	
CAx-Online-Generator http://www.siemens.com/cax	
Tender specifications http://www.siemens.com/specifications	

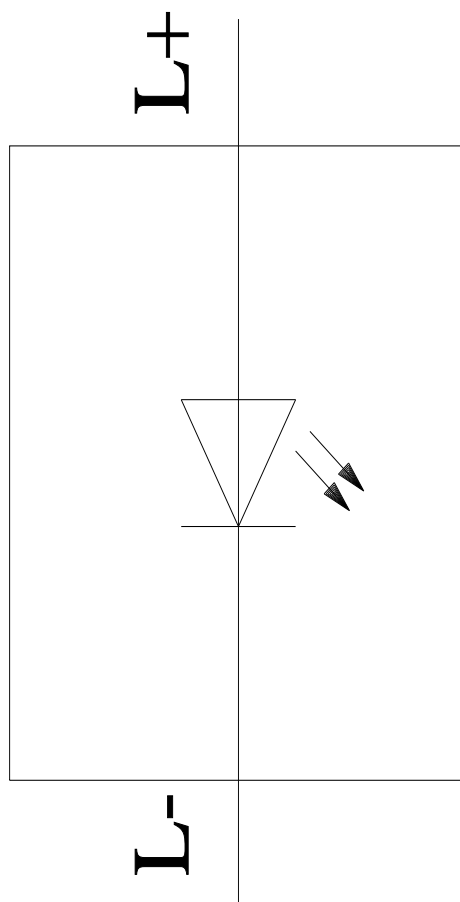
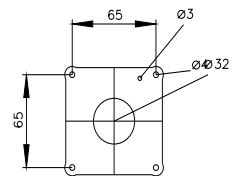
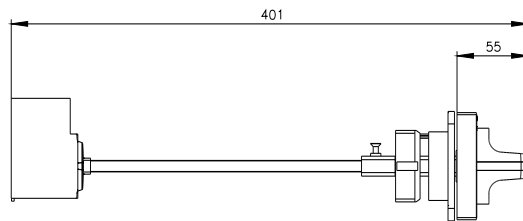
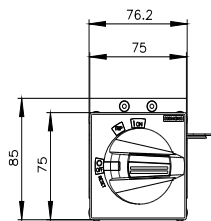

last modified:

12/20/2020

