

Product datasheet

Specifications



energy sensor, PowerTag Monoconnect, 250 A, 3P+N

LV434021

Main

Range of product	PowerLogic
Product name	PowerTag M250
Product or component type	Energy sensor
Poles	3P + N
Maximum current [Imax]	250 A
[Ib] basic current	40 A
Starting current	160 mA
Saturation current	500 A
Product specific application	Energy management Overload alarm Power factor Load monitoring Circuit monitoring
Concentrator compatibility	Acti9 Smartlink SI B Acti9 Smartlink SI D Acti9 PowerTag Link C Acti9 PowerTag Link Acti9 PowerTag Link HD Harmony Hub Wiser IP module EcoStruxure Panel Server Universal EcoStruxure Panel Server Advanced PrismaSet Active
Range compatibility	Compact NSX Compact NSX100...250 Compact INV Compact INV100...250 Compact NS Compact NS100...250 Compact INS Compact INS250-100...250 EasyPact EasyPact CVS100 EasyPact EasyPact CVS160 EasyPact EasyPact CVS250
Type of measurement	Active and reactive energy Active and reactive power Apparent power Current Voltage Power factor
Accuracy class	Class 1 active energy conforming to IEC 61557-12 Class 2 reactive energy conforming to IEC 61557-12 Class 1 active power conforming to IEC 61557-12 Class 2 reactive power conforming to IEC 61557-12 Class 2 apparent power conforming to IEC 61557-12 Class 1 current conforming to IEC 61557-12 Class 0.5 voltage conforming to IEC 61557-12 Class 1 power factor conforming to IEC 61557-12
Metering type	Power factor 0...1: class 1 at 25 °C conforming to IEC 61557-12 Active energy Ep IN/OUT/tot 0...281 x 10exp(9) kWh: class 1 at 25 °C conforming to IEC 61557-12 Reactive energy Ep IN/OUT/tot 0...281 x 10exp(9) kVARh: class 2 at 25 °C conforming to IEC 61557-12 Voltage U12, U23, U31 320...480 V: class 0.5 at 25 °C conforming to IEC 61557-12

	Voltage V1N, V2N, V3N 184...276 V: class 0.5 at 25 °C conforming to IEC 61557-12 Current I1, I2, I3, Iavg 8...250 A: class 1 at 25 °C conforming to IEC 61557-12 Apparent power S, S1, S2, S4 88 VA...416 kVA: class 2 at 25 °C conforming to IEC 61557-12 Active power P, P1, P2, P4 88 W...416 kW: class 1 at 25 °C conforming to IEC 61557-12 Reactive power Q, Q1, Q2, Q4 88 VAR...416 kVAR: class 2 at 25 °C conforming to IEC 61557-12 Frequency 45...65 Hz
Mounting location	Bottom
Mounting support	On circuit breaker
Connection pitch	35 mm
Product destination	Switchboard
Event management	Voltage loss with measured current at voltage loss
Transmission support medium	Radio frequency 2.4...2.4835 GHz conforming to IEEE 802.15.4 (11...26) transmission time < 5 ms
Maximum emission power	10 mW

Complementary

[Imp] maximum permanent current	1.2 x In
Mounting mode	Bolt-on
Tightening torque	10 N.m
Supply voltage	230 V AC, +/- 20 %, between phase and neutral 400 V AC, +/- 20 %, between phases
Network frequency	50 Hz 60 Hz
Maximum power consumption	3.7 VA
Standards	IEC 61557-12 IEC 61010-1 ETSI EN 301 487-1 IEC 61010-2-030 IEC 61326-1 ETSI EN 300 328
Height	57 mm
Width	140 mm
Depth	86 mm
Net weight	300 g
Colour	Dark grey (RAL 7016)

Environment

Quality labels	CE
Directives	2014/53/EU - radio equipment directive
Operating altitude	0...2000 m
Ambient air temperature for operation	-25...70 °C
Ambient air temperature for storage	-50...85 °C
Overvoltage category	IV conforming to IEC 61010-1
Measurement category	Category III conforming to IEC 61010-2-030
IP degree of protection	IP20
IK degree of protection	IK07 conforming to IEC 60068-2-75 test Ehb
Pollution degree	3
Relative humidity	0...95 % at 55 °C conforming to IEC 60721-3-3
Vibration resistance	3M4 conforming to IEC 60721-3-3
Electromagnetic compatibility	Industrial electromagnetic environment conforming to IEC 61326-1

	Radiated EMC conforming to ETSI EN 301 489-17 Electromagnetic emission conforming to IEC 62311
Environmental characteristics	Indoor use

Packing Units

Unit Type of Package 1	PCE
Number of Units in Package 1	1
Package 1 Height	13.0 cm
Package 1 Width	11.0 cm
Package 1 Length	17.3 cm
Package 1 Weight	536.0 g
Unit Type of Package 2	S02
Number of Units in Package 2	4
Package 2 Height	15.0 cm
Package 2 Width	30.0 cm
Package 2 Length	40.0 cm
Package 2 Weight	2.5 kg
Unit Type of Package 3	P06
Number of Units in Package 3	64
Package 3 Height	71.5 cm
Package 3 Width	80.0 cm
Package 3 Length	60.0 cm
Package 3 Weight	47.0 kg

Offer Sustainability

Sustainable offer status	Green Premium product
REACH Regulation	REACH Declaration
EU RoHS Directive	Compliant EU RoHS Declaration
Mercury free	Yes
China RoHS Regulation	China RoHS declaration
RoHS exemption information	Yes
Environmental Disclosure	Product Environmental Profile
Circularity Profile	End of Life Information

Contractual warranty

Warranty	18 months
----------	-----------

Dimensions

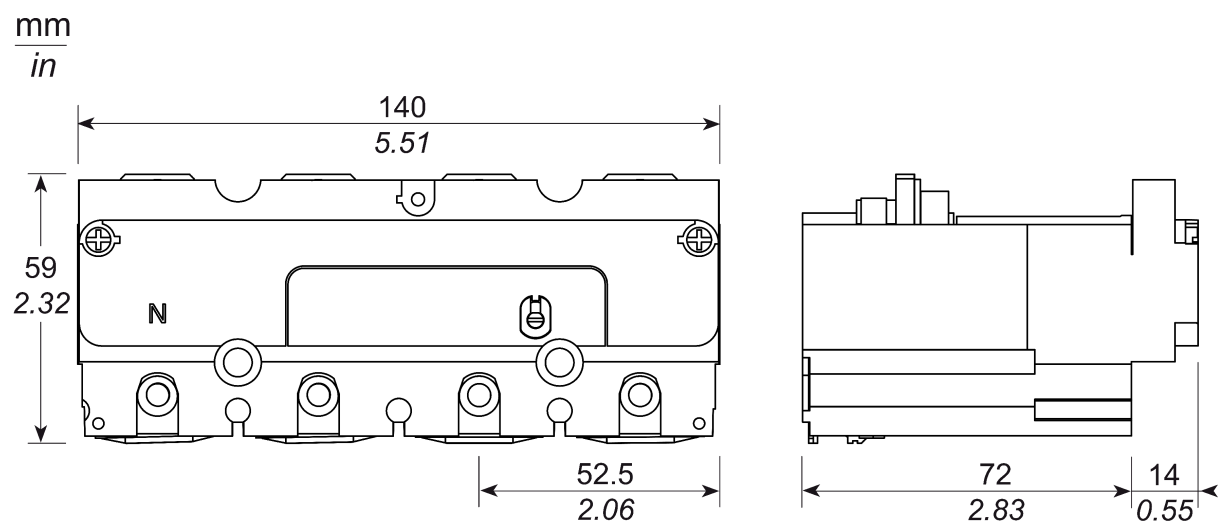

Recommended replacement(s)